



AFS-GC90
MAGNESIUM OXIDE SPREADER

Operators Manual



Reese Engineering Ltd

Palmerston North, New Zealand
Telephone: +64 6 357 9323
Facsimile: +64 6 354 3155
www.reeseagri.com







Contents

| | |
|---|-----------|
| OWNER INFORMATION | 4 |
| PRODUCT DESCRIPTION | 5 |
| ORDERING SPARE PARTS | 5 |
| RECEIVING DELIVERY | 5 |
| RIGHT HAND AND LEFT HAND | 5 |
| SAFETY PRECAUTIONS..... | 6 |
| SAFETY FIRST | 7 |
| OPERATE YOUR MACHINE SAFELY | 7 |
| WEAR PROTECTIVE GEAR | 7 |
| BE SAFE WITH CHEMICALS..... | 8 |
| DISPOSE OF WASTE PROPERLY | 8 |
| AGRISPRED™ MAGNESIUM OXIDE SPREADER OPERATION..... | 9 |
| ADJUSTING THE SPREADING RATE | 9 |
| SPREADING RATE CALIBRATION | 10 |
| QUICK RELEASE HOPPER | 11 |
| MAINTENANCE | 12 |
| CLEANING | 12 |
| CLUTCH BUSH..... | 12 |
| RIGHT ANGLE GEARBOX..... | 12 |
| WHEEL BEARINGS | 12 |
| PARTS MANUAL | 13 |
| BASE FRAME ASSEMBLY | 13 |
| BASE FRAME ASSEMBLY | 14 |
| HOPPER AND SHROUD ASSEMBLY..... | 15 |
| DRAWBAR ASSEMBLY..... | 16 |



Owner Information

Congratulations on the purchase of your new AGRISPRED™.

The AGRISPRED™ range of fertiliser spreaders has been designed and manufactured with the discerning farmer in mind. Having regarded ever increasing costs of farm machinery today, our company has attempted to provide long-term durability by using the finest materials in the construction of our spreaders.

This manual deals with the assembly, calibration, use and maintenance of our complete range of spreader models. Read it thoroughly before attempting to use your spreader. If you are still unsure about any aspect of the spreader, ask the dealer who supplied the machine to explain any unclear points.

Your AGRISPRED Dealer is:

Name ō

Address ō

 ō

Phone No ō

Date Purchased ō

Model No ō

Serial No



Product Description

| | |
|--------------------|-----------------|
| Model | AFS-GC90 |
| Type | Gear Drive |
| Capacity | 85 litres |
| Height | 1.24m |
| Width | 1.44m |
| Tare Weight | 87kg |
| Wheel Size | 18 x 8.5 x 8+ |

Distributes: All Powdered Products
Width of Spread: Up to 4 metres (Depending on product and weather conditions)
Application Rate: From 2.5g to 15g per square metre

Ordering Spare Parts

Always order your spare parts for your spreader through your authorised AGRISPRED™ dealer. Use the AGRISPRED™ part number and description as given in the parts manual. Please include:

- Quantity required
- Machine size
- Model number
- Machine serial number

The serial number can be found on the plate on the frame of your AGRISPRED™ Magnesium Oxide Spreader.

Always request and use only factory original parts. Failure to use factory parts will void the warranty and any liability of Reese Engineering Limited whether implied or otherwise.

Receiving Delivery

Carefully check for any damage that may have occurred during transit, and if necessary, ensure that a claim is lodged with the common carrier concerned prior to accepting delivery.

Right Hand and Left hand

Reference in this manual to right hand and left hand is taken by viewing the machine from behind and in the direction of travel.



Safety Precautions

Be aware of your ATV or other farm vehicles load carrying capacity. Excess weight whether attached or placed on an ATV or Farm vehicle, can dramatically change the vehicles handling characteristics.

- Never overload the spreader, maximum payload is 55kg.
- Ensure the tow vehicle is safe and appropriate for the task, maximum tare weight of a fully loaded spreader is 142kg.
- Never allow any persons to ride on the spreader.
- Ensure that the product to be spread is of good quality and is free of stones and/or lumps.
- Check tyres are inflated to the correct pressure. This should be 10-12 psi (68-82 kpa).
- Never exceed 15kph even when the spreader is empty.
- Check all bolts are tight especially drawbar mount and hopper quick release locking bolts.
- Never leave unused product in hopper or store the spreader without cleaning it. Magnesium oxide will set hard if exposed to air and/or moisture, which may result in damage to components. The hopper is best filled at point of application.
- Never travel long distances with hopper loaded if not spreading. Magnesium oxide will pack down and may jam the agitator.
- Ensure all moving parts are clean and free from Magnesium Oxide build up.
- This implement is not designed for towing on any road. It is designed for on farm use only.



Safety First

Keep your machine in proper working condition. Unauthorised modifications to the machine may impair the function and/or safety and affect machine life.

If you do not understand any part of this manual and need assistance, contact your AGRISPRED™ dealer.

OPERATE YOUR MACHINE SAFELY

Be careful when operating machine to avoid injury.

Serious injury or death can result from contact with electric lines. Use care when moving or operating the machine near electric lines to avoid contact.



Be careful when operating on hillsides, tractor can tip sideways if it strikes a hole, ditch or other irregularity.

Permit only one person, the operator, on tractor platform while tractor and planter are in operation. Keep riders off. They are subject to injury such as being struck by foreign object and being thrown off the machine. They also obstruct the operators view.

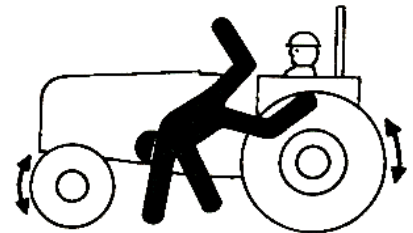

WEAR PROTECTIVE GEAR

Wear close fitting clothes and safety equipment appropriate to the job.

Wear suitable hearing protective device as prolonged exposure to loud noise can cause impairment or loss of hearing.



Wear safety gloves when working with discs as they can have sharp edges.

Operating equipment safely requires the full attention of the operator. Do not wear radio headphones while operating machine.



BE SAFE WITH CHEMICALS

Direct exposure to agricultural and hazardous chemicals can cause serious injury. Potentially hazardous chemicals used with AGRISPRED™ equipment include such items as lubricants, coolants, fertiliser, paint and adhesives. If in doubt, contact your local AGRISPRED™ dealer for information about chemical safety and first aid procedures.

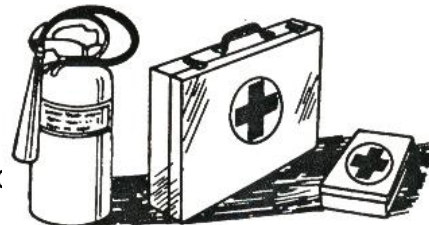

Keep all parts in good condition and properly installed. Fix damage immediately. Replace worn or broken parts. Remove any build-up of grease, oil, or debris.

Remove paint before welding or heating. Avoid potentially toxic fumes and dust when sanding, repainting or welding. Do all work outside in a well-ventilated area. Dispose of paint and solvent properly.

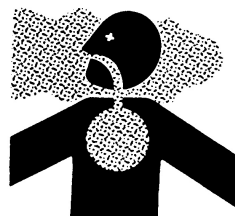

Avoid heating near pressurised fluid lines or other flammable materials. Pressurised lines can be accidentally cut when heat goes beyond the immediate flame, which could result in severe burns to yourself and bystanders.

Avoid high-pressure fluids. Escaping fluid under pressure can cause injury. Relieve pressure before disconnecting hydraulic or other lines.

DISPOSE OF WASTE PROPERLY

Improper disposing of waste can threaten the environment and ecology. Use leak-proof equipment when draining fluids. Do not use food or beverage containers that may mislead someone into drinking from them.



Do not pour waste onto the ground, down a drain, or into any water source. Use the manufactures directions on the correct way to recycle or dispose of waste



AGRISPRED™ Magnesium Oxide Spreader Operation

Adjusting the spreading rate

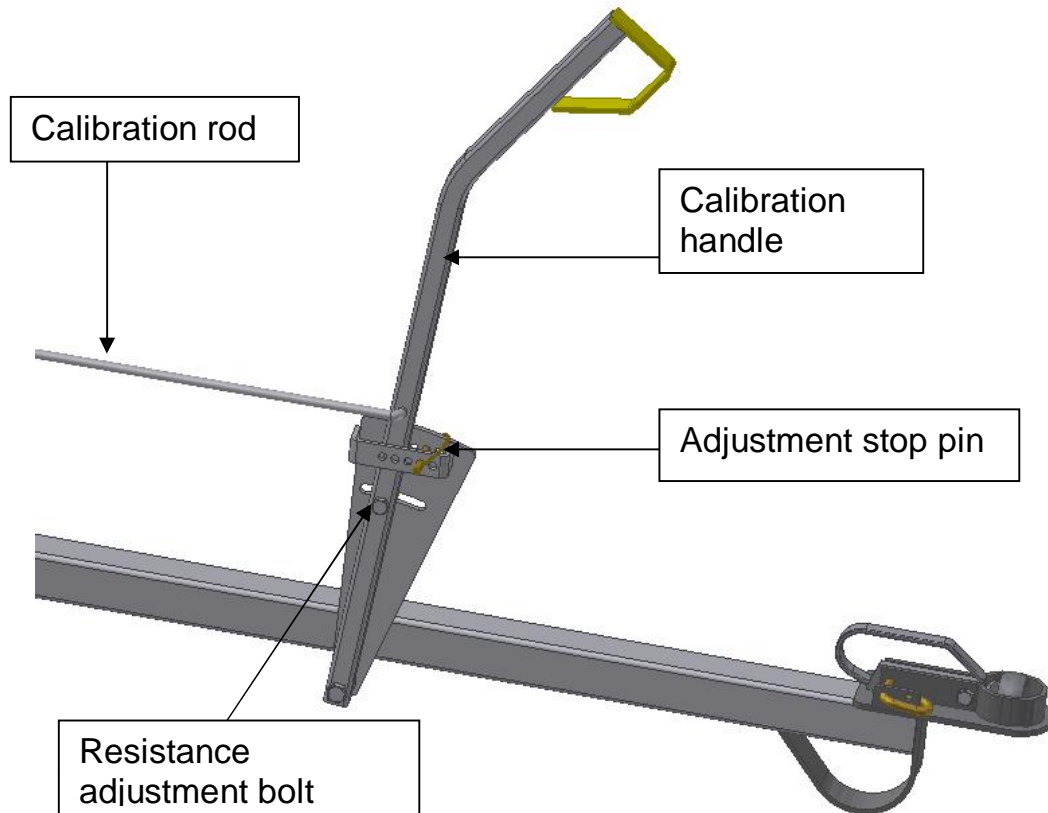

- To alter the rate of product being dropped onto the spinning disc the adjustment stop pin can be located in one of four holes.
- The calibration handle is pulled forward onto the adjustment stop pin when spreading is to commence.
- When travelling to the job the calibration handle should be locked back in the upright position.
- If the handle should need more spring resistance the Nylock nut should be tightened on the resistance adjustment bolt.



Spreading rate calibration @ 10-12kph

| | Adjustment stop pin position | Product application grams per metre squared (g/m ²) at 12k/ph |
|------|------------------------------|---|
| Low | 1 | 2.5 |
| | 2 | 5.1 |
| | 3 | 8.5 |
| High | 4 | 13.2 |

Note: these rates are a guide only as product variations; weather and speed all have a big impact on calibration.

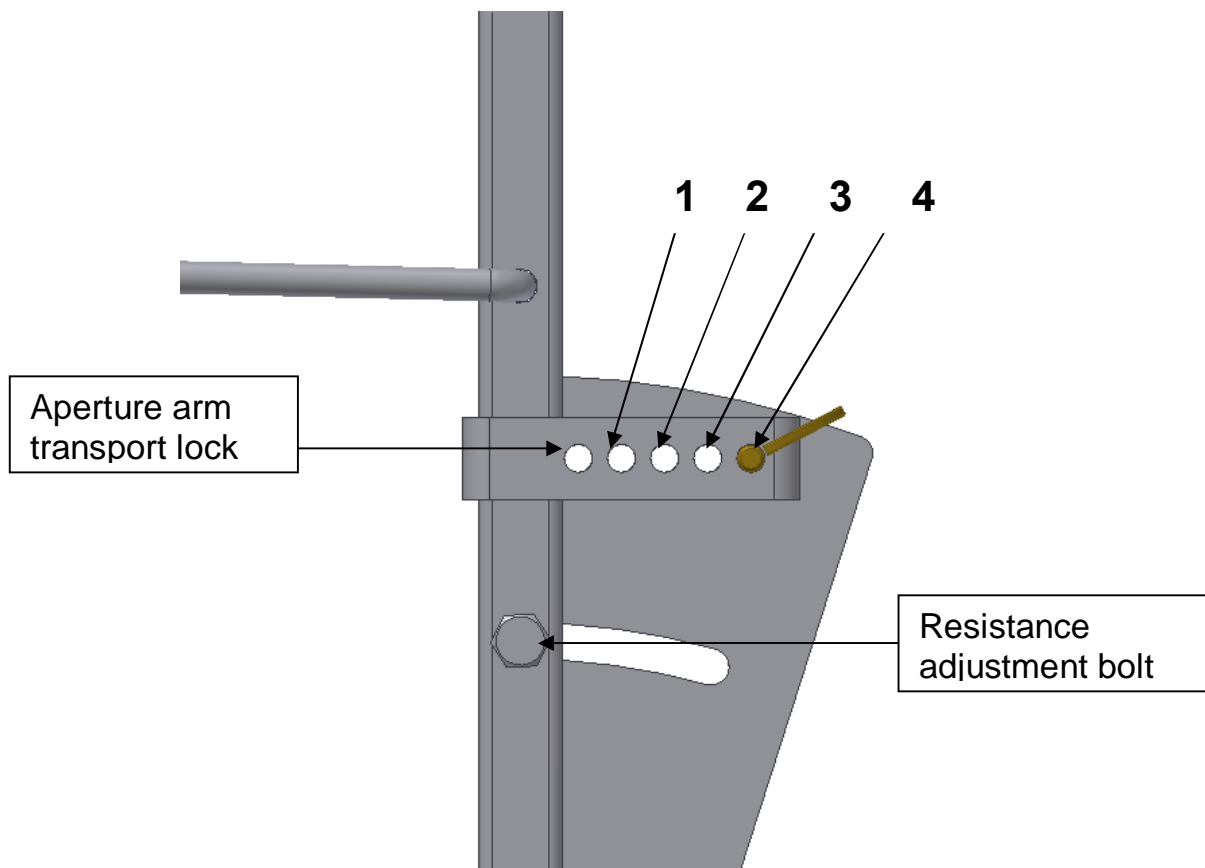

Magnesium oxide is applied at a rate determined by the number of cows to be treated. When applying this product calculate the amount required then select the appropriate setting for the calibration stop pin.



Quick release hopper

The AGRISPRED™ magnesium oxide spreader is equipped with a quick release hopper* that will aid in cleaning and the removal of any unused product.

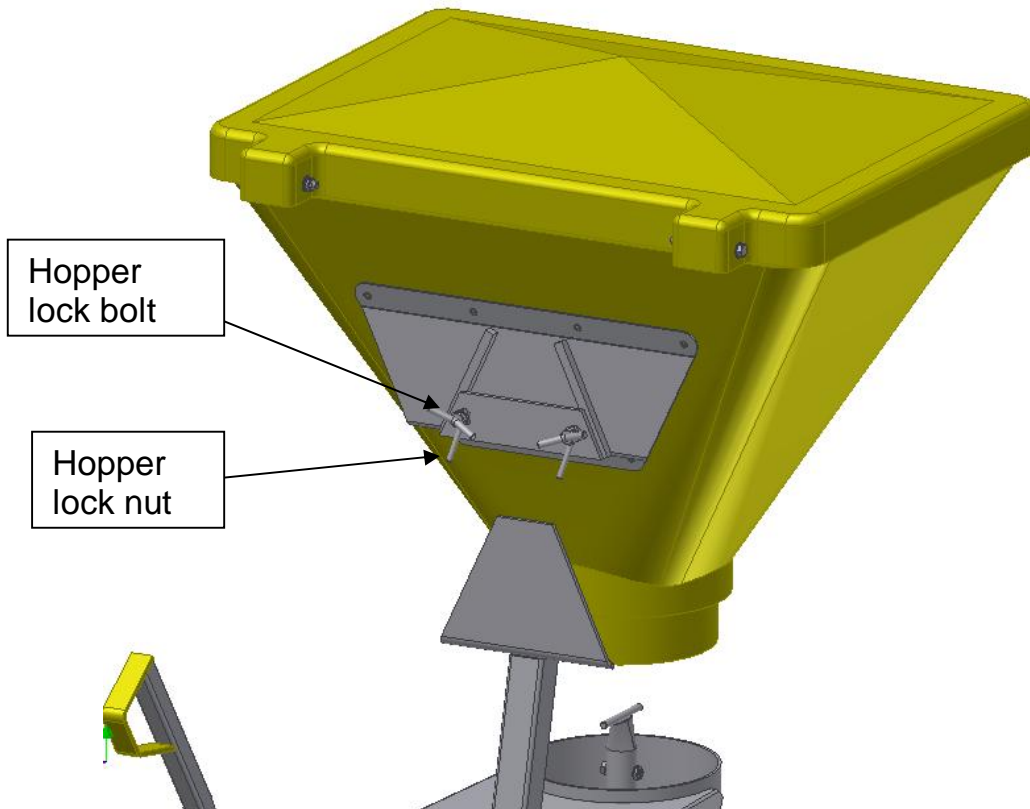

- To remove the hopper, loosen hopper locknuts then loosen hopper lock bolt, the hopper will lift off easily.
- Be sure when the hopper is refitted that the hopper lock bolt are done up firm and then locked off with the hopper lock nut to ensure that the hopper is stable during operation.

* The AGRISPRED™ Magnesium Oxide Spreaders quick release hopper and fully enclosed integral mudguard/deflector is a copyrighted design.



Maintenance

Reese Agri and AGRISPRED™ recommend the following maintenance to ensure that the Magnesium Oxide spreader will perform as intended, and to maximise the machines longevity.

Cleaning

The spreader should be thoroughly cleaned after each use either by washing or brushing. If a water blaster is to be used care must be taken around the seals of the gearbox and wheels as high pressure water can enter the seal and damage will occur.

Clutch Bush

After washing/cleaning the spreader clutch bush should be greased. This is made easier by leaving the pin in which will help the grease travel around the grease groove.

Right Angle Gearbox

The gearbox is factory filled with oil but will need checking occasionally; only ST90 type oil may be used. The level is determined by the bung when the spreader is on its side. Oil should be changed after 30 hours of use and then every 50 hours thereafter.

Wheel Bearings

The wheel bearings are packed with grease from the factory and should be trouble free, but an occasional check for free play is recommended and possibly repacking with grease or bearing replacement.

Parts Manual

Base Frame Assembly

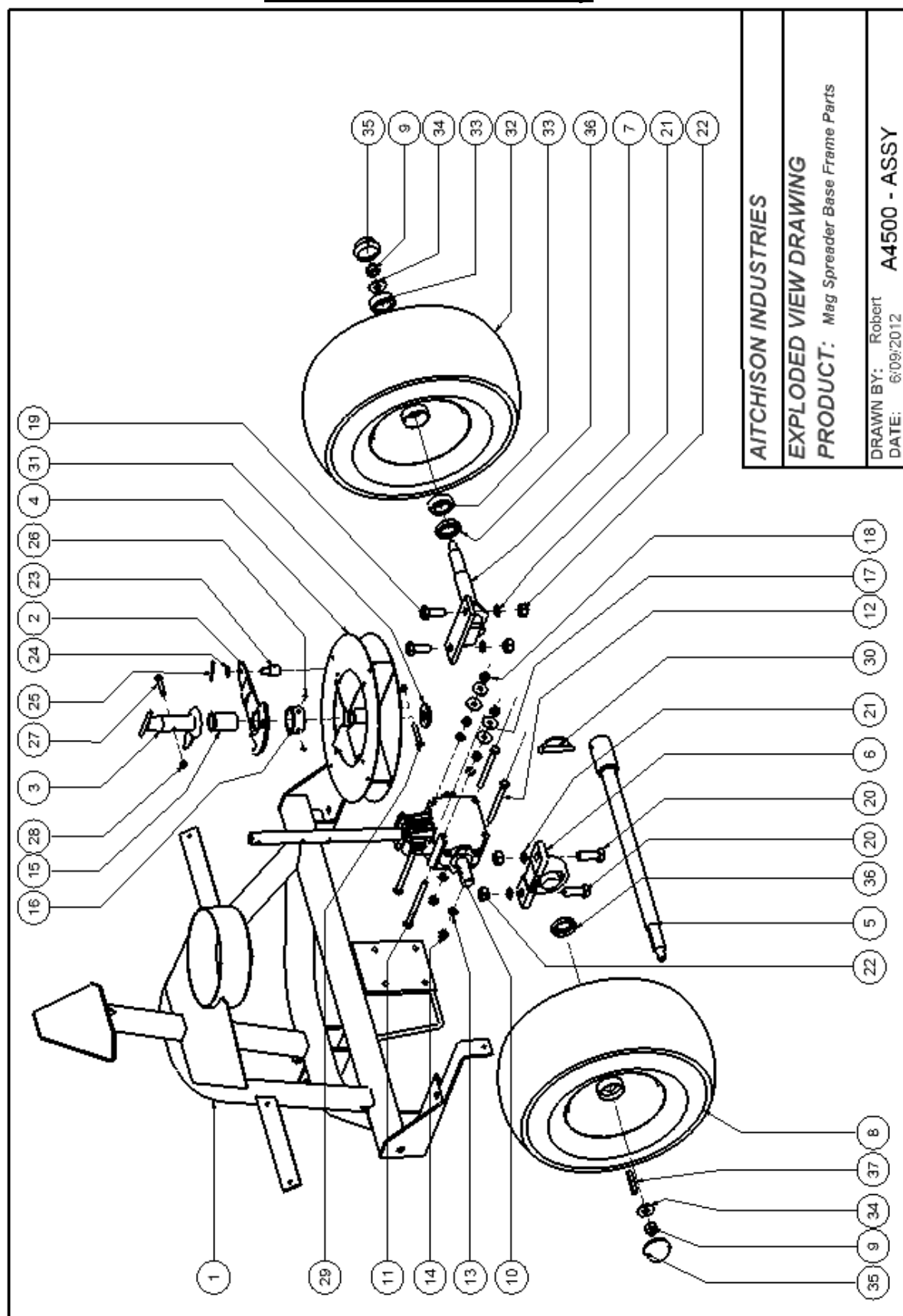

Base Frame Assembly

AITCHISON INDUSTRIES

EXPLODED VIEW DRAWING

PRODUCT: Mag Spreader Base Frame Part Numbers

DRAWN BY: Robert
DATE: 6/09/2012

A4500 - ASSY

| Parts List | | | Parts List | | | | |
|------------|-----|----------------------------------|-------------|------|-----|-----------------------------|-------------|
| ITEM | QTY | DESCRIPTION | PART NUMBER | ITEM | QTY | DESCRIPTION | PART NUMBER |
| 1 | 1 | Causmag Spreader Frame Assembly | A4501-ASSY | 20 | 2 | Bolt ZP | 8619H |
| 2 | 1 | Apperture Arm Assembly | A4503 | 21 | 4 | Spring Washer ZP | 9061 |
| 3 | 1 | Causmag Agitator Assembly | A4504 | 22 | 4 | Nut ZP | 9161 |
| 4 | 1 | Spinning Disc Assembly | A4505 | 23 | 1 | Swivel Collar | A2334 |
| 5 | 1 | Right Axle (Drive Axle) Assembly | A4629 | 24 | 1 | Stainless Steel Flat Washer | 9039S |
| 6 | 1 | Bearing Housing | 9223/9224 | 25 | 1 | R Clip | 9279 |
| 7 | 1 | Axle Assembly | A1602 | 26 | 2 | Grub Screw | 82151 |
| 8 | 1 | Keyed Wheel | A1608 | 27 | 1 | SS Bolt | 8309S |
| 9 | 2 | Nyloc Nut | 16A | 28 | 2 | Nylock Nut | 9105S |
| 10 | 1 | Gearbox | A4606 | 29 | 1 | SS Bolt | 8308S |
| 11 | 2 | Bolt ZP | 8416H | 30 | 1 | Shaft Locking pin | A4621 |
| 12 | 2 | Bolt ZP | 8402H | 31 | 1 | Rubber Washer | A4620 |
| 13 | 4 | Spring Washer ZP | 9041 | 32 | 1 | Wheel | A38522 |
| 14 | 4 | Nut ZP | 9141 | 33 | 2 | Bearing Body | |
| 15 | 1 | Plastic Bush | A4517 | 34 | 2 | HD Flat Washer | 9062 |
| 16 | 1 | Apperture Arm Retainer | A4506 | 35 | 2 | Cap Hub | A4623 |
| 17 | 4 | Penny Washer | 9037 | 36 | 2 | Seal | |
| 18 | 2 | Nylock Nut | 9142 | 37 | 1 | Key | A4622 |
| 19 | 2 | Bolt ZP | 8602H | | | | |

Hopper and Shroud Assembly

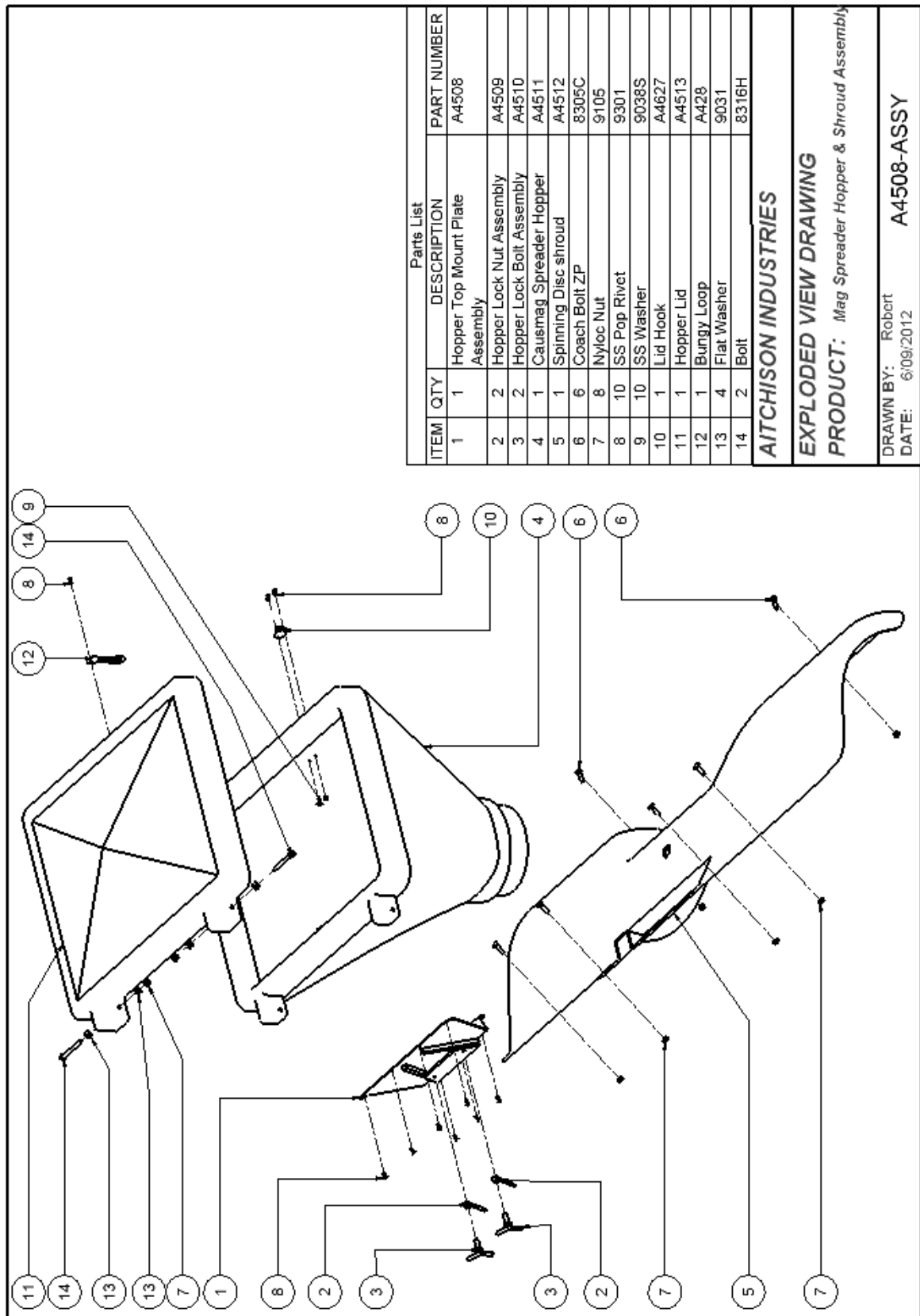

Drawbar Assembly

